



2021 Models



LEXOR TS | LEXOR FL
Ram ProMaster Chassis

Pleasure-Way



35 YEARS IN THE MAKING

Pleasure-Way Industries Ltd. is pleased to be celebrating its 35th year as a leader in the RV manufacturing industry. A family-owned and-operated business since its inception in 1986, Pleasure-Way is committed to building the highest-quality luxury motorhomes.

Pleasure-Way's unwavering commitment to quality, safety, and customer satisfaction is evident in the fact that we do not mass produce our motorhomes on assembly lines; rather each motorhome is hand-crafted and custom-fitted to exacting standards and rigorous quality inspections. Due to our meticulous, labour-intensive construction process, we are proud to have one of the lowest warranty claim rates in the entire RV industry. In fact, we are so confident in the quality of our motorhomes that we back each new Pleasure-Way with our Five Year Freedom Coach Warranty—one of the best and longest warranties in the industry.

We would never be where we are today without our team of dedicated and skilled employees, or without the enthusiastic support from our owners. We are deeply grateful for everyone that has been involved with Pleasure-Way over the past 35 years and we look forward to continuing to deliver a first-class RV experience.

CONTENTS

| | | | |
|-------------------|---|-----------------------|----|
| Models | 2 | Build Your Own | 11 |
| Standard Features | 3 | The Pleasure-Way Life | 13 |
| Optional Features | 6 | Specifications | 14 |
| Lexor TS | 7 | Warranty | 15 |
| Lexor FL | 9 | Personal Assistant | 15 |



NINE CONSECUTIVE RVDA QUALITY CIRCLE AWARDS

This distinguished recognition reinforces our core company values of hard work, superior quality, and top-notch customer service.

RAM PROMASTER MODELS

LEXOR TS



| | |
|----------------------------|--------------------|
| Fuel Type: | Gasoline |
| Standard Engine: | 3.6L V6 Pentastar |
| Length: (bumper to bumper) | 20' 11" / 637 cm |
| Overall Height: | 9' 3.5" / 283 cm |
| Width: | 7' 5" / 226 cm |
| LP Tank Capacity: | 4.7 US Gal / 18 L |
| Fresh Water Tank Capacity: | 29 US Gal / 109 L |
| Grey Water Tank Capacity: | 20 US Gal / 75 L |
| Black Water Tank Capacity: | 12 US Gal / 45 L |
| Towing Capacity: | 2,150 lbs / 975 kg |

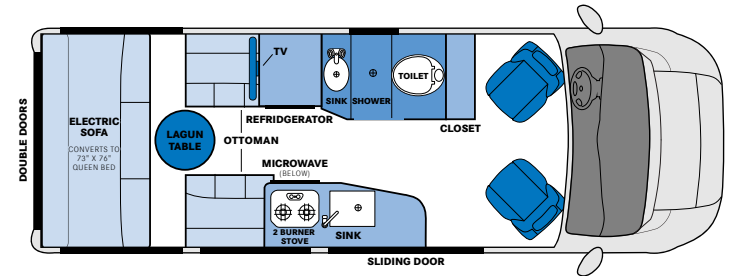

LEXOR FL



| | |
|----------------------------|--------------------|
| Fuel Type: | Gasoline |
| Standard Engine: | 3.6L V6 Pentastar |
| Length: (bumper to bumper) | 20' 11" / 637 cm |
| Overall Height: | 9' 3.5" / 283 cm |
| Width: | 7' 5" / 226 cm |
| LP Tank Capacity: | 4.7 US Gal / 18 L |
| Fresh Water Tank Capacity: | 29 US Gal / 109 L |
| Grey Water Tank Capacity: | 20 US Gal / 75 L |
| Black Water Tank Capacity: | 12 US Gal / 45 L |
| Towing Capacity: | 2,150 lbs / 975 kg |

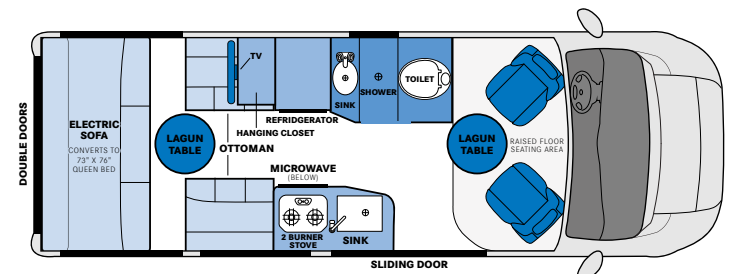



STANDARD FEATURES

Here at Pleasure-Way, we are committed to producing first-class motorhomes with exceptional features. To achieve this, we only select high-performing suppliers that deliver the best possible products and superior services. Our commitment to quality is further supported by including these high-end features as standard, rather than offering a complicated list of optional and expensive add-ons. Below, you will find a compelling list of innovative, reliable, and sophisticated standard features, all designed to give you the utmost confidence in your Pleasure-Way motorhome.



ECO-ION 200AH LITHIUM BATTERIES

The high-performing, fast-charging and maintenance-free coach batteries offer superior power storage for hassle-free use of your favourite devices.



XANTREX™ 2,000 WATT INVERTER

Provides power to the TV, Blu-ray™ player, microwave, induction stove, and most 120 VAC receptacles when you're not plugged into shore power or running the generator.



TRUMA AQUAGO® COMFORT PLUS WATER HEATER

The 60k BTU stepless burner, recirculating water line, and mixing vessel deliver hot water on demand, at even temperatures, eliminating temperature spikes.



ENTERTAINMENT CENTER

Includes a Bose® Bluetooth® soundbar and 24" LG Smart LED TV. Enjoy broadcast TV in HD with the inclusion of the fully automatic Winegard® Rayzar digital TV antenna.



STAINLESS STEEL GALLEY SINK

The large, 13" x 17" x 6 3/4" galley sink is complemented by a high-arc faucet with pull-out sprayer. This combination makes filling large pots and clean-up much easier.



LAMINATE INTERIOR

Laminate is scratch-resistant, highly durable, and easy to maintain, resulting in a long-lasting solid plywood interior.



LED LIGHTING

LED lights are energy efficient, dimmable, provide a clean and stylish appearance, and do not produce heat like regular incandescent or halogen lights.



LAGUN TABLE MOUNT SYSTEM

A cantilevered support arm offers adjustable height, eliminates the typical center post, and swivels 360° at both the table top and support arm.



MEMORY FOAM SOFA CUSHIONS

Assembled with a medium density foam base, 3" of memory foam on top, and finished with a layer of Dacron, resulting in a cooler bed with a smooth, seamless finish.



MCD ROLLER SHADES

Designed for solar protection and made of 100% light blocking material, MCD roller shades cover the windows for complete blackout privacy within the coach.



CORIAN® SOLID SURFACES

This impact resistant material is non-porous, stain-resistant, and easy-to-clean. Rest assured, Corian® keeps its good looks and easily survives daily wear and tear.



ULTRALEATHER® FABRIC

Innovative strengthening technology makes this luxurious fabric exceptionally durable and stain-resistant. It's also pet friendly, scratch-resistant, and easy-to-clean.



FRONT CAB PRIVACY SHADES

Fully form fitting to your windshield and cab doors, these shades provide privacy and protect your dash from UV damage while helping to keep the coach interior cooler.



INFLATABLE AIR BED

The inventive, one-piece air bed neatly sits overtop the two front seats and provides a cozy, 61" x 27" bed. Enjoy the ability to sleep an extra passenger on your next trip.





STANDARD FEATURES

The two, seven-inch touchscreen control panels allow you to easily control several functions of your coach.

SEVEN-INCH TOUCHSCREEN CONTROL PANEL

AUTOMATIC GENERATOR START (AGS)

AGS allows the user to set start and stop parameters for generator control when not plugged into shore power.

Low Coach Battery Voltage

You can activate the AGS so that if the coach batteries are low on voltage, the generator will automatically start and run to charge the batteries to your pre-defined voltage, then turn off.

Automatic Climate Control

If the temperature exceeds your preset AC thermostat setting, the generator will automatically start and run the AC until the desired temperature has been reached. This is a great feature if you are traveling with pets.

DIAGNOSTICS

This page allows you to easily check the status of all 12V appliances and identify whether the feature is on and functioning properly.

CLIMATE CONTROL

On the homepage of the control panel you can control the furnace, air conditioning and power roof vent. You also have the ability to set the power vent to automatically turn on and circulate air in the coach. The vent also has a rain sensor in case you get caught away from the coach the vent will automatically close.

LED LIGHTING CONTROLS

On the homepage you can customize three light switches which will be displayed for quick access. A separate lighting page contains switches for all individual banks of lights as well as a master on and off feature. All interior LED lights are individually dimmable.

12 VOLT NET GAIN / LOSS AMPERAGE METER

This real-time amp meter allows you to see exactly how much 12V electricity you are consuming while dry camping or how much free electricity you are gaining through your solar panels. This eliminates the need to guess your electricity consumption while dry camping.

OPTIONAL FEATURES



REAR DOOR ROLL-UP SCREEN

If you're the type who loves fresh air and a cool breeze, you'll love our screen door options. The heavy-duty nylon canvas screen precisely fits the rear opening and features a super-fine mesh, keeping insects out and only letting fresh air in. The screen door also features a double zipper system that allows for easy access to the under sofa storage space. This flame-resistant screen can be rolled up, tethered, and conveniently hidden away when not in use.



SIDE DOOR ROLL-UP SCREEN

Enjoy the beauty of the outdoors while prepping a meal without the worry of insects ruining the party. A unique magnetic closure system allows for easy access in and out without the need to zip the door open and closed. The super-fine mesh screen and door assembly are constructed from heavy-duty, flame-resistant nylon canvas, resulting in a long-lasting, reliable feature. When the screen is not needed it can be rolled up and secured out of the way.



GO POWER!® SOLAR PACKAGE

Extend your off-the-grid adventures with the addition of our solar options. This system provides power to the coach batteries, allowing for use of the 12V DC system and 120 VAC receptacles through the inverter. This gives you greater dry camping abilities without the need for shore power or running the generator. Choose from:

- 100-Watt (5 amp) package
- 200-Watt (10 amp) package
- 300-Watt (15 amp) package



EXTERIOR PAINTED PLASTIC MOLDINGS

Painted front and rear bumpers and side moldings add to Pleasure-Way's clean automotive styling.



LEXOR TS

RAM PROMASTER 3500

The Lexor TS is constructed on the Ram ProMaster chassis which features a slightly wider platform, allowing for a roomy and open feel throughout the coach.

When equipped with the optional rear and side door screens, it becomes simple to enjoy nature and let fresh air into the coach without the worry of insects. This layout boasts our most expansive wet bath, excellent storage, a large Corian® kitchen countertop and an extremely comfortable queen size bed, all while staying under 21 feet in length.



LAMINATE INTERIOR

The wet bath is wrapped in laminate, resulting in a scratch resistant, waterproof, highly durable and long-lasting interior.



QUEEN BED

Making the enormous 73" x 76" memory foam queen bed is effortless using the power sofa and ottoman cushions.



SPACIOUS GALLEY AREA

Locating the galley on the passenger side leaves the sliding door clear of obstruction allowing for an open view of your campsite.



PRIVATE WET BATH

The fully equipped wet bath features a medicine cabinet, Corian® countertop, storage compartment, china bowl toilet, and handheld showerhead.



LEXOR FL

RAM PROMASTER 3500

The Lexor FL floorplan is designed with a forward lounge providing versatility in use and configuration. Both front seats can swivel to take advantage of the flip-up workstation and optional Lagun table location.

A relocated wardrobe provides space directly behind the driver's seat. This allows for full rearward seat placement without limiting recline. The Ram chassis allows for a deeper galley, wider hallway and a roomy wet bath. The rear of the coach features our power sofa which provides legendary comfort either as a sofa or when deployed as a queen bed.



POWER SOFA

Convenience is built into the power sofa/bed configuration. The memory foam sofa will convert into twin singles or a 73" x 76" queen bed.



FLIP-UP WORKSTATION

Get the most out of this workspace with use of the 120V power outlet, USB charging ports and swivelling front seats.



INTERIOR STORAGE

Everything is easily within reach with the generously sized bank of upper cabinets, wardrobe for hanging clothes, and additional storage below the countertop.



PRIVATE WET BATH

Fully equipped with a medicine cabinet, Corian® countertop, stainless steel sink, under sink storage, china bowl toilet, handheld showerhead, and lined with waterproof laminate.

BUILD YOUR OWN

SOLID MAPLE CABINETRY



Blonde



Mocha

HIGH GLOSS LAMINATE



White Chocolate Radius (Optional)

CORIAN® COUNTERTOPS



Carbon Aggregate Concrete



Neutral Aggregate Concrete

ULTRALEATHER® FABRIC



Graphite



Almond

The exterior color available for the Lexor is Bright Silver Metallic.





Mark Haskell | Lake Superior



Forrest Hinx



Anna Wilson Mangiafico | Texas, USA

THE PLEASURE-WAY LIFE

Traveling in a Pleasure-Way motorhome affords some unique advantages over traditional RVing in a larger Class A, Class C or pull-type trailer. There are the more obvious advantages of stress-free driving, easy and accessible parking, and the ability to explore 'off the beaten track' locations.

You'll have the ability to visit friends and relatives for family functions, reunions, graduations, and weddings. No more hotel reservations or inconveniencing your host. The strategic design of our motorhomes ensure a quick and easy set up once you arrive at your destination. Since all your amenities are covered, you are free to be spontaneous with your adventures without compromise.

Whether you are a seasoned full-timer or an RV newbie, something has drawn you into the Pleasure-Way lifestyle. Memories will be created, friends will be made, and stories will be shared!

PLEASURE-WAY AMBASSADOR CREW

We believe our best salespeople are happy owners, and the PAC program offers the opportunity to reward members for their efforts to promote our motorhomes.

We provide our members with personalized PAC cards to hand out to potential clients or interested parties. These cards are used to gain loyalty rewards for both parties upon purchase of a new Pleasure-Way motorhome.

Visit pleasureway.com/pac to sign up and learn more.

PLEASURE-WAY OWNERS' CLUBS

We believe that meeting new friends and sharing adventures is an important part of the Pleasure-Way experience. A wonderful group of people have formed our Pleasure-Way owners' clubs and are based on the East and West Coasts of the United States and Western Canada. Owners have fallen in love with the Pleasure-Way lifestyle and actively participate in our club rallies. Pleasure-Way owners' clubs are operated and run by owners who enjoy the RV lifestyle and share the same passion for Pleasure-Way.



Visit us at pleasureway.com for more information on how to join and participate in Pleasure-Way owners' clubs, events, and rallies.

COACH SPECIFICATIONS

| | TS | FL |
|---|----|----|
| ENTERTAINMENT | | |
| 24" Smart LED TV w/ Blu-ray™ player | • | • |
| Bose® soundbar w/ Bluetooth® | • | • |
| Winegard® Rayzar® Automatic HDTV antenna | • | • |
| Cable TV hook up | • | • |
| USB charging ports | • | • |
| INTERIOR | | |
| Inflatable air bed fitted for cab | • | • |
| MCD blackout roller shades w/ magnetic catch | • | • |
| Privacy/sun shades for windshield & cab doors | • | • |
| Hardwood maple cabinet doors | • | • |
| Blum® cabinet hinges and door stays | • | • |
| Laminate-wrapped kitchen, wall partitions & cabinets | • | • |
| Premium vinyl flooring | • | • |
| Soft touch vinyl headliner | • | • |
| Flip-up workstation | | • |
| GALLEY | | |
| 3-way, 4.9 cu. ft. refrigerator/freezer | • | • |
| 2-burner LP flush mount stove w/ glass cover | • | • |
| Corian® solid surface countertop | • | • |
| 13"x17" stainless steel sink w/ faucet & pull-out sprayer | • | • |
| Microwave/convection oven | • | • |
| BATHROOM | | |
| Private wet bathroom w/ shower | • | • |
| Vanity w/ storage, stainless sink & Corian® countertop | • | • |
| SEATING AREA | | |
| Lagun table mount system w/ 360° swivel tabletop | • | • |
| Power sofa w/ two three-point seat belts | • | • |
| Memory foam sofa cushions | • | • |
| Ultraleather® fabric | • | • |
| HEATING, VENTILATION & COOLING | | |
| Auto-ignite 16,000 BTU furnace | • | • |
| Power lift Fan-Tastic Vent fan w/ rain sensor | • | • |
| Low profile 11,000 BTU roof mount air conditioner | • | • |

| | TS | FL |
|--|-----|-----|
| ELECTRICAL | | |
| Multiplex wiring w/ dimmable LED lighting | • | • |
| Dual 7-inch touchscreen control panels | • | • |
| Dual 100Ah Eco-Ion lithium (LiFePO4) coach batteries | • | • |
| Xantrex™ 2000-Watt Pure-sine wave inverter | • | • |
| 80-amp lithium charger | • | • |
| 12-volt coach battery disconnect | • | • |
| 2.8 KW Onan® gas generator w/ AGS | • | • |
| Mastervolt Mac Plus DC-DC charger | • | • |
| 30-amp power cord | • | • |
| PLUMBING & LIQUID PROPANE SYSTEMS | | |
| Truma AquaGo® comfort plus instant water heater | • | • |
| Shurflo® automatic demand water system | • | • |
| LP BBQ quick connect | • | • |
| Tank level monitoring – LP, fresh, grey and black | • | • |
| EXTERIOR | | |
| Power awning w/ LED lights | • | • |
| Exterior shower w/ handheld wand | • | • |
| Hitch and wiring | • | • |
| COACH OPTIONS | | |
| High gloss radius laminate cabinetry | • | • |
| Painted exterior moldings | • | • |
| Solar package (100W to 300W) max W | 300 | 300 |
| Rear door roll-up screen | • | • |
| Side door roll-up screen | • | • |

WEIGHTS & MEASUREMENTS

| | LEXOR TS | LEXOR FL |
|---------------------------|------------------|------------------|
| Length (bumper to bumper) | 20' 11" / 637 cm | 20' 11" / 637 cm |
| Width (side mirrors ext.) | 8' 2.5" / 250 cm | 8' 2.5" / 250 cm |
| Width (side mirrors ret.) | 7' 5" / 226 cm | 7' 5" / 226 cm |
| Overall height | 9' 3.5" / 283 cm | 9' 3.5" / 283 cm |
| Interior standing height | 6' 3" / 190 cm | 6' 3" / 190 cm |
| Fresh water tank capacity | 29 US gal / 109L | 29 US gal / 109L |
| Grey water tank capacity | 20 US gal / 75 L | 20 US gal / 75 L |

CHASSIS SPECIFICATIONS

| | LEXOR TS | LEXOR FL |
|---------------------------------|---------------------------|---------------------------|
| Chassis | Ram Promaster 3500 | Ram Promaster 3500 |
| GVWR | 9,350 lbs / 4,241 kg | 9,350 lbs / 4,241 kg |
| GCWR | 11,500 lbs / 5,216 kg | 11,500 lbs / 5,216 kg |
| Standard engine | 3.6 L V6 Pentastar | 3.6 L V6 Pentastar |
| Fuel type/tank capacity | Gas/24 US gal/90 L | Gas/24 US gal/90 L |
| HP rating | 283 HP | 283 HP |
| Torque rating | 260 ft-lbs | 260 ft-lbs |
| Wheelbase | 159 inches | 159 inches |
| Transmission (auto) | 6-spd Auto | 6-spd Auto |
| Locking fuel fill | No | No |
| Chassis air conditioning | Yes | Yes |
| Power windows, locks, mirrors | Yes | Yes |
| Remote keyless entry | Yes | Yes |
| Steering wheel positioning | Telescopic | Telescopic |
| Breaking system | Disc Brakes w/ABS | Disc Brakes w/ABS |
| Stability and traction control | Electronic Stability Ctrl | Electronic Stability Ctrl |
| Tire pressure monitoring | Yes | Yes |
| Tires (all season) | LT225 / 75R / 16 | LT225 / 75R / 16 |
| Alternator/chassis battery | 220 amp / 12v 95Ah | 220 amp / 12v 95Ah |
| Air bags (driver & pass.) | Yes | Yes |
| Nav/Bluetooth®/audio | Yes | Yes |
| Rear view camera system | Yes | Yes |
| Swivel seating (driver & pass.) | Yes | Yes |
| Smart wheel functions | Yes | Yes |

| | LEXOR TS | LEXOR FL |
|-----------------------------|--------------------|--------------------|
| Black water tank capacity | 12 US gal / 45 L | 12 US gal / 45 L |
| LP gas tank capacity | 4.7 US gal / 45 L | 4.7 US gal / 45 L |
| Towing capacity | 2,150 lbs / 957 kg | 2,150 lbs / 957 kg |
| Queen bed size | 73" W X 76" L | 73" W X 76" L |
| Driver side rear single bed | 26" W X 76" L | 26" W X 76" L |
| Pass. side rear single bed | 26" W X 76" L | 26" W X 76" L |



LEXOR TS



LEXOR FL



WARRANTY

PLEASURE-WAY WARRANTY

All Pleasure-Way motorhomes are backed by our Five Year Freedom Warranty. Pleasure-Way Industries Ltd. warrants the specified new Pleasure-Way Motorhome free from defects in material and craftsmanship, on portions manufactured by Pleasure-Way Industries Ltd. under normal use and service.

Coverage - 5 years or 60,000 miles / 100,000 kms

Limited Warranty

RAM WARRANTY

Basic Limited Warranty

- Coverage - 3 years or 36,000 miles / 60,000 kms

Powertrain Limited Warranty:

- Coverage - 5 years or 60,000 miles / 100,000 kms

Roadside Assistance

- 5 years or 60,000 miles / 100,000 kms



PLEASURE-WAY PERSONAL ASSISTANT

We understand that it takes time to get completely familiarized with your new motorhome and all of its features. For this reason, you will be designated your very own Pleasure-Way Personal Assistant for the first 90 days of ownership!

Your P.A. is a specialized and knowledgeable member of the Pleasure-Way team who works right here in our manufacturing facility. Upon receiving the warranty registration of your new motorhome, your P.A. will provide you with their contact information. You will now have access to your Pleasure-Way P.A. six days a week, via a dedicated, toll-free phone number or email.

Your Pleasure-Way P.A. will be there to assist you in all matters pertaining to the operation of your Pleasure-Way motorhome. After your 90 day period expires, you will have all the confidence and knowledge to enjoy your new Pleasure-Way for years to come!



PLEASURE-WAY INDUSTRIES LTD.

302 Portage Avenue
Saskatoon, SK,
Canada S7J 4C6

Tel: 800.364.0189
www.pleasureway.com

 facebook.com/PWindustries

 youtube.com/user/pleasureway

 [@pleasurewayrv](https://twitter.com/pleasurewayrv)

 [@pleasurewayrv](https://instagram.com/pleasurewayrv)



Due to our policy of continuous improvements, Pleasure-Way Industries Ltd. reserves the right to make product changes at any time without notice and without incurring obligations whatsoever, including but not limited to: prices, styling, design, colors, construction, equipment, materials, and specifications. Some motorhomes depicted in the brochure may be shown with optional equipment. Please see your dealer for additional information or contact Pleasure-Way Industries Ltd. Estimated fuel consumption may vary depending on conditions and driving habits. Estimates are based on consumer feedback.